



THE
shore
CBD KOTA KINABALU

Unobstructed Sea View

PREMIER OCEANVIEW HUB
RESIDENTIAL SUITES | SERVICED RESIDENCE | RETAIL

International Connectivity

Sabah is a must-visit tourist hotspot within Asia. Its strategic location en route to many places such as China, Hong Kong, Japan, Korea and even Australia makes it the destination of choice for a layover. Those seeking fun in the sun will find plenty of play time in the sand and sea from sunrise to sunset. Those who come to stay can look forward to relaxing island life.



Land Below the Wind

Sabah is the heart of Borneo, an island that offers pristine waters, lush rainforests, majestic mountains and an adventurous playground for tourists and thrill-seekers who love to explore.



Hike @ Mount Kinabalu



Rafflesia @ Kinabalu Park



Adventure @ Kota Kinabalu Adventure Park



Dive @ Sipadan Island



White Water Rafting @ Kiulu White Water Rafting



Experience @ Kota Kinabalu Wetlands



Orang Utan @ Sandakan Sepilok Orang Utan Rehabilitation Centre



Shopping @ Gaya Street Sunday Market

Prime Location with Panoramic View of KK City

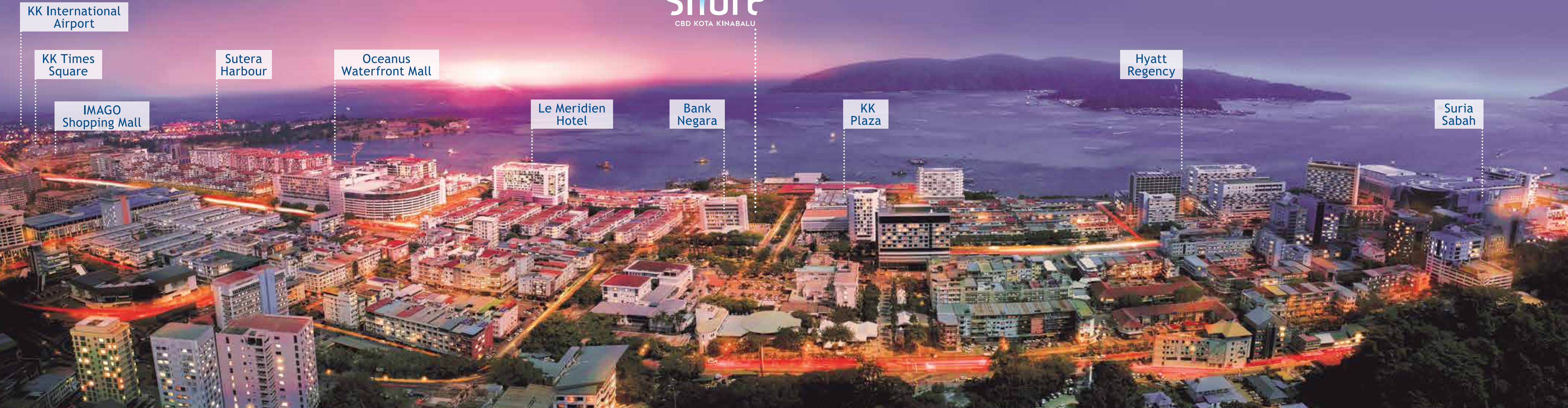

KK International Airport

KK Times Square

Sutera Harbour

Oceanus Waterfront Mall

Le Meridien Hotel

Bank Negara

KK Plaza

Hyatt Regency

Suria Sabah

IMAGO Shopping Mall

On the Water's Edge

The Shore is strategically located in the heart of KK city, surrounded by 360° conveniences and a wide range of amenities.

Excellent Feng Shui

Good luck and fortune flows to The Shore, as it faces the sea and the property itself is back to back with Bank Negara.



HOTELS

- 1 Hyatt Regency Hotel
- 2 Jesselton Hotel
- 3 Le Meridien
- 4 Shangri-La Hotel
- 5 Promenade Hotel
- 6 Tang Dynasty Hotel

SHOPPING

- 1 Wisma Merdeka
- 2 KK Plaza
- 3 Warisan Square Shopping Mall
- 4 Centre Point Shopping Mall
- 5 Karamuning Complex
- 6 Oceanus Waterfront Mall
- 7 Wawasan Plaza
- 8 IMAGO Shopping Mall

Superb connectivity to everywhere within the city. Travelling to and from The Shore is easy, breezy and convenient.



Aerial view

The Tallest Residential Building in KK City Centre

INDULGENT NICETIES SECURED (SERVICED RESIDENCE)

URBAN NEEDS FULFILLED (RESIDENTIAL SUITES)

LIFESTYLE THERAPY SATISFIED (RETAIL)



International Hotel Living

citadines

APART' HOTEL

Managed by The Ascott Limited

These serviced suites are nestled on a prime area right next to an international hotel, making this residential tower one of the most valuable investments in KK city.

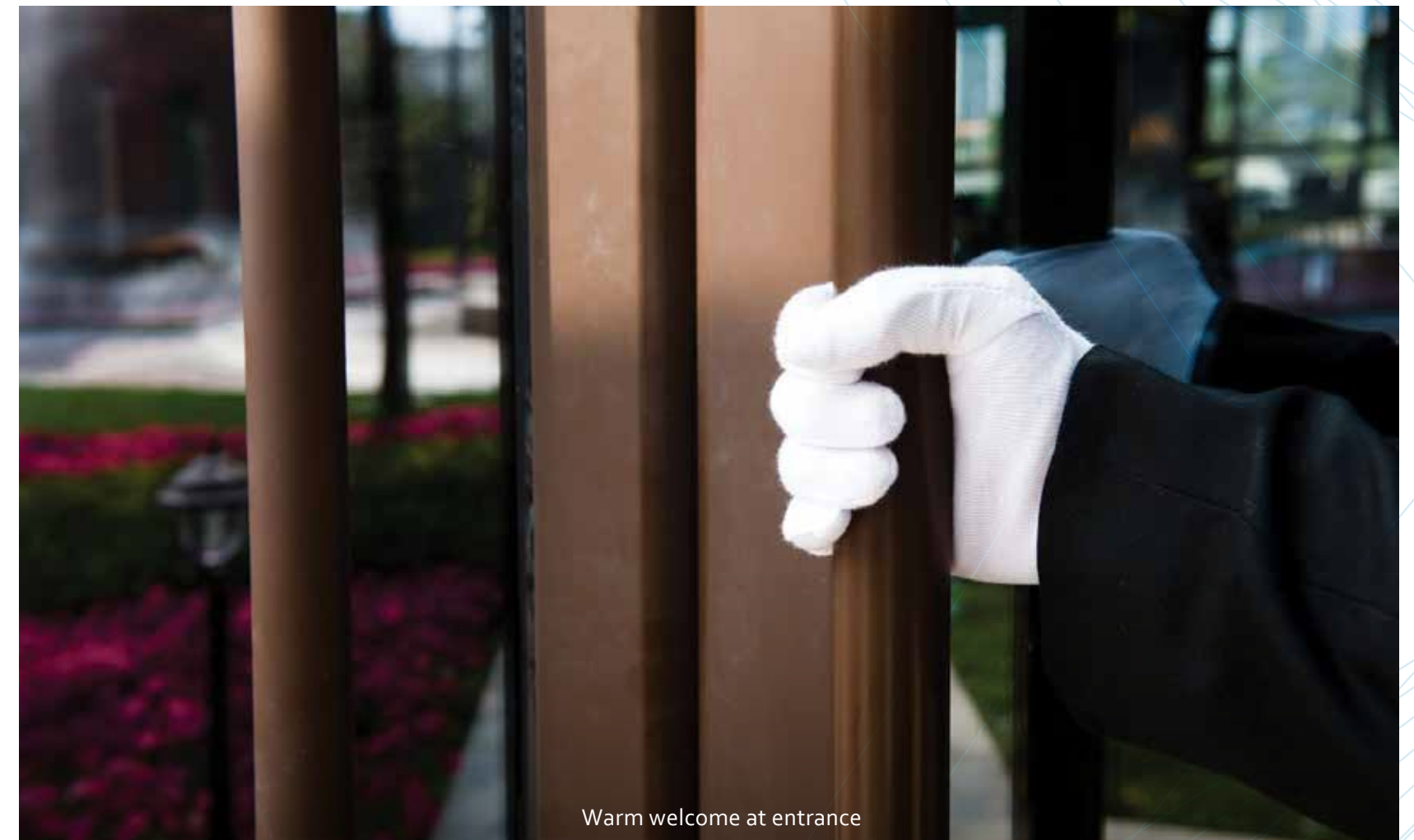

Warm welcome at entrance

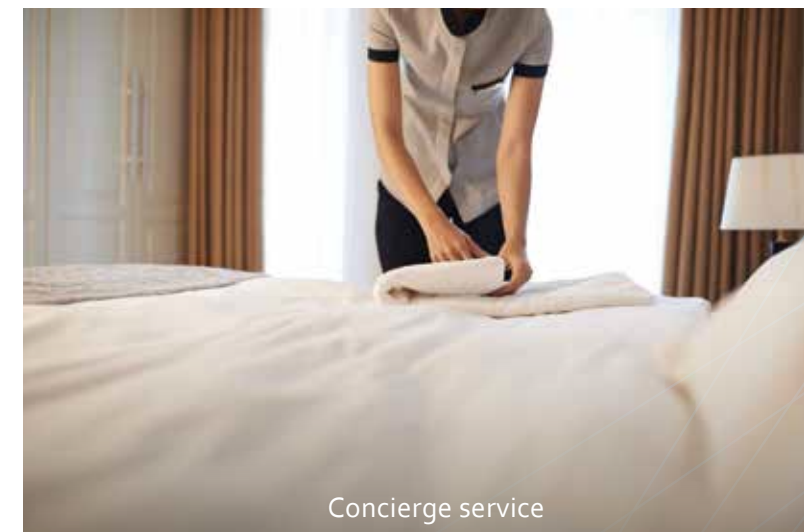

Concierge service

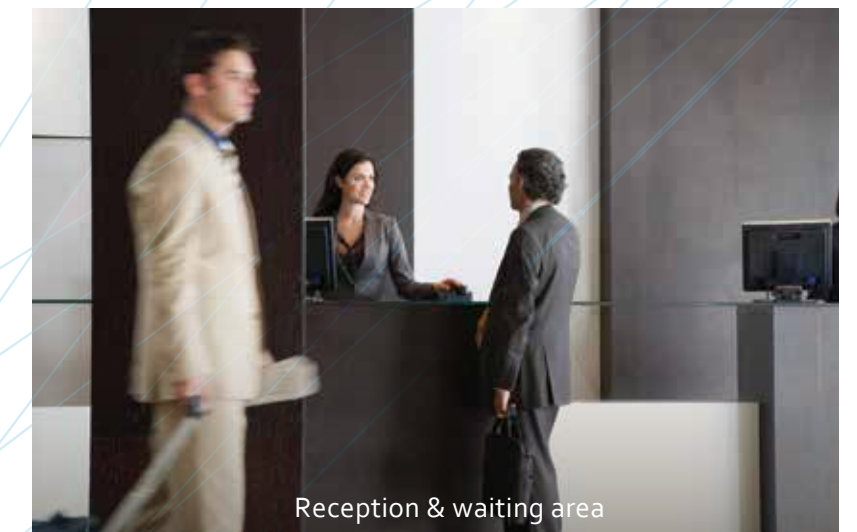

Reception & waiting area

See-Through Infinity Pool



Grand drop-off area



Terrace



Facilities

- Rotating Sky Bar
- Observation Deck
- Pool Deck
- Swimming Pool
- Wading Pool
- Children's Playground
- Terrace
- Hammock Garden



The First Rotating Sky Bar in KK

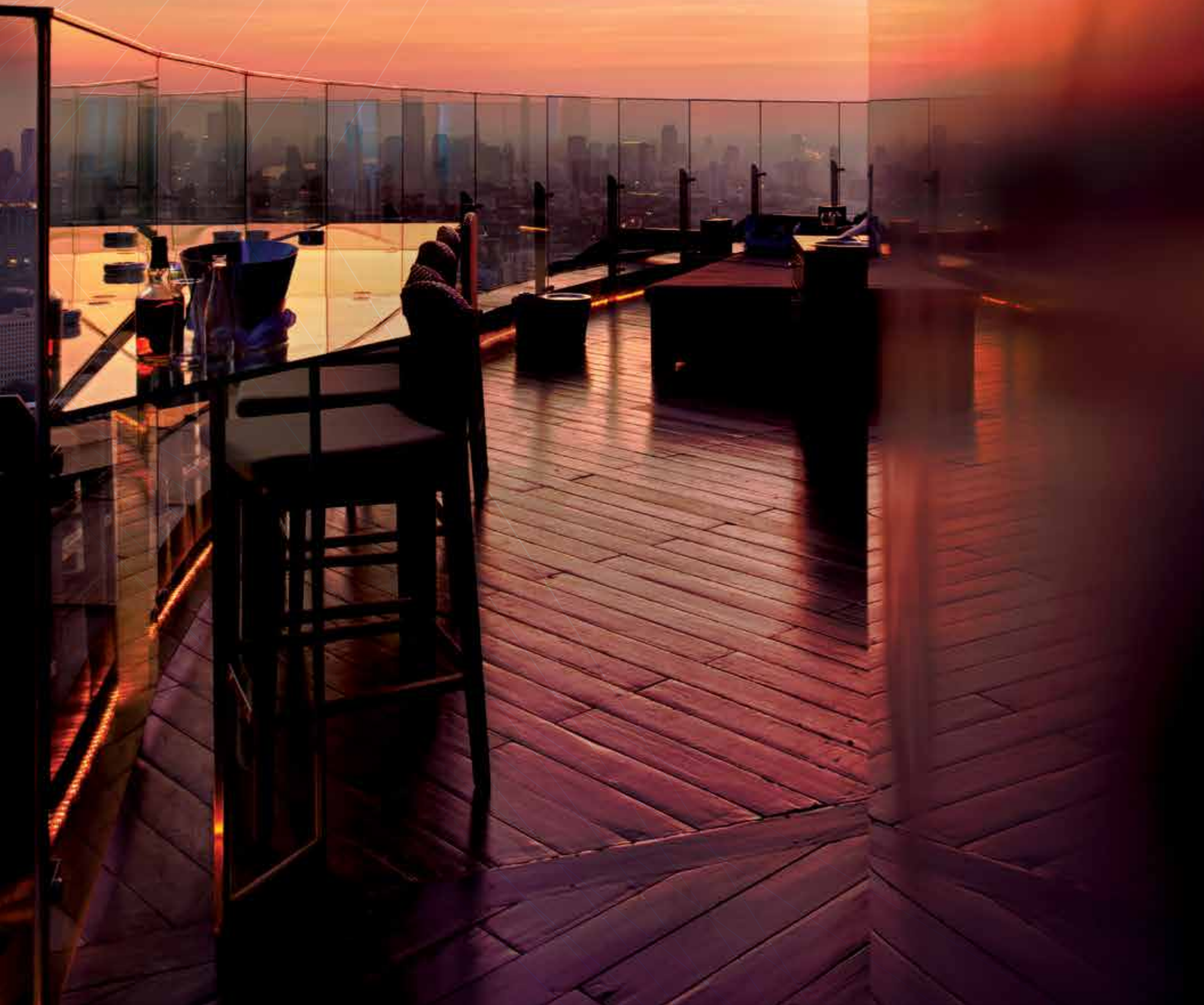

Rooftop garden & gazebo



Rooftop garden

FLOOR PLANS

AURA
498 sq ft

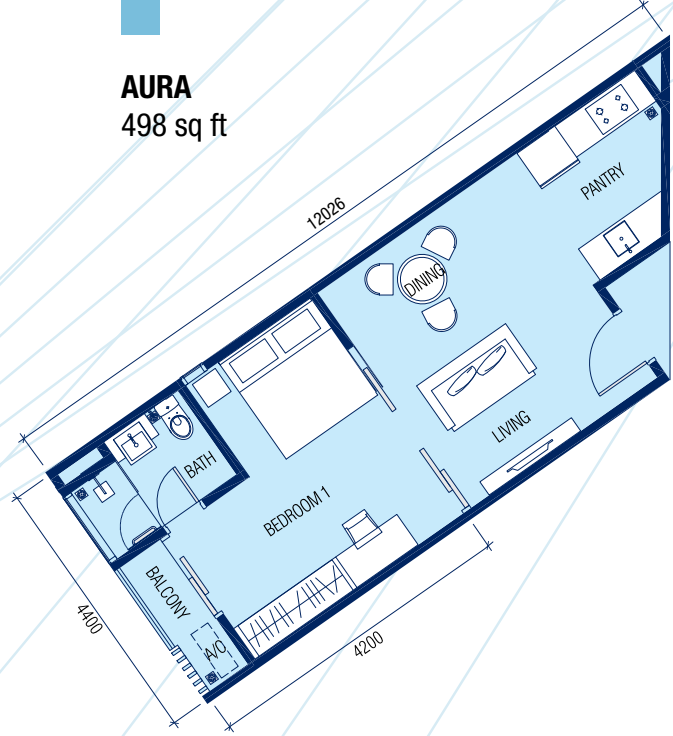

AURA 2
489 sq ft

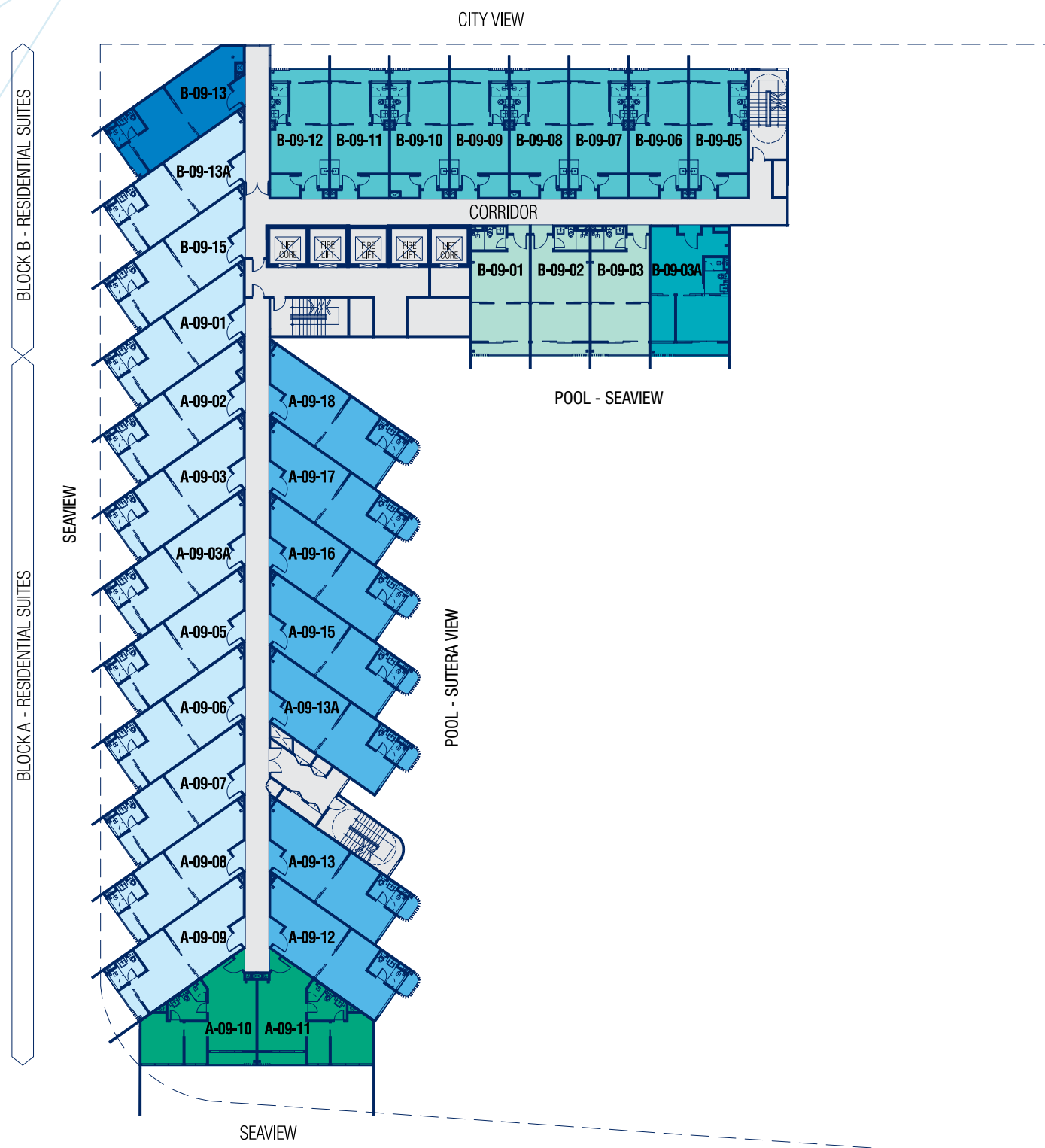

CORAL
505 sq ft

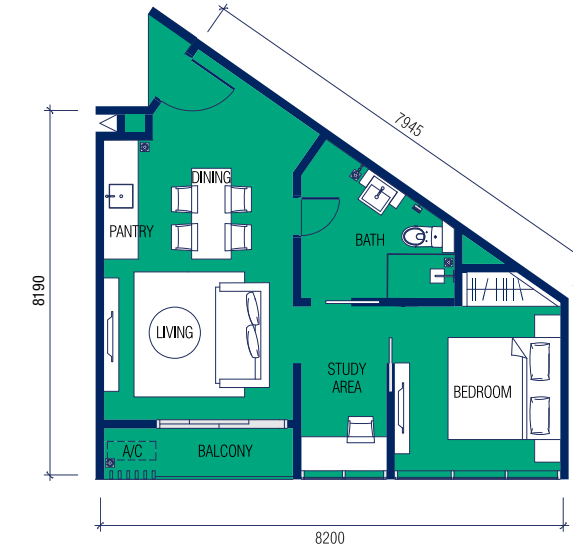

AURA 1
517 sq ft



- **AURA** - 498 sq ft
- **AURA 1** - 517 sq ft
- **AURA 2** - 489 sq ft
- **BEACH** - 409 sq ft
- **BEACH 1** - 409 sq ft
- **BEACH 2** - 541 sq ft
- **CORAL** - 505 sq ft

Premier Residence Suites by the Sea



Developer
BLU Waterfront Development Sdn Bhd (820786-P)
DBKK No. C-2-6 (C17-3) Level 3, Block C,
Harbour City, Jalan Pantai Baru, Sembulan,
88100 Kota Kinabalu, Sabah.

Sales Gallery
Lot 61, Ground Floor Building K, KK Times Square,
Off Coastal Highway, 88100 Kota Kinabalu, Sabah.
T 088 258 708 F 088 258 707
W www.theshore.my

For more information, call
010 943 8888

Developer's Licence No.: (100-24/1219/1/1)01-2021/05491 - Validity Date: 26.01.2017 - 25.01.2021 - Advertising & Sales Permit No.: (100-24/1219/1/1)01-2021/04491 - Validity Date: 26.01.17 - 25.01.2021 - Land Tenure: Leasehold (54 years) - Expected Date Of Completion: 2021 - Type of Property: Serviced Apartment - Total Units: 578 - Price: RM 475,000.00 (min) - RM670,000.00 (max)
- Land Encumbrances: United Overseas Bank (M) Bhd - Approving Authority Development & Building Plans: Kota Kinabalu City Hall - Building Plan Reference No: BP/160/05.15/L/101/V - All monies including deposit / booking fee must be paid into Housing Developer's Account No. 2563008166 with United Overseas Bank (M) Bhd - 30% Bumiputra reserved with 5% discount - The information contained herein is subject to change and cannot form part of an offer or contract. All renderings are artist's impressions only. All measurements are appropriate. All plans are intended to serve as a guide only and are subject to approval by the relevant approving authorities and may be modified or amended as directed by the approving authorities and/or project consultants. All built ups indicated are approximate measurements only and are subject to final survey/confirmation by the land surveyor/appropriate authorities. While every reasonable care has been taken in preparing this material, the developer cannot be held responsible for any inaccuracy. The numbering and postal address for the said/parcel when issued by the appropriate authority may not be the identical description as stated in this brochure. Any dispute arising therein shall not be the subject matter of any claims for damages, compensation and/or whatsoever.